

## BUILT-IN WIRELESS WATERPROOF DIGITAL INDICATORS



WATERPROOF

DATA OUTPUT



2505-10WL

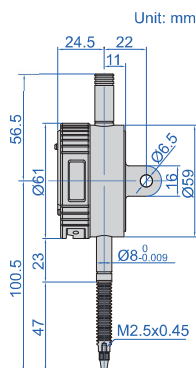

2505-101WL/2505-10WL



2505-25WL

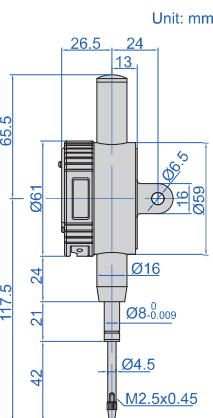

2505-251WL/2505-25WL



2505-50WL

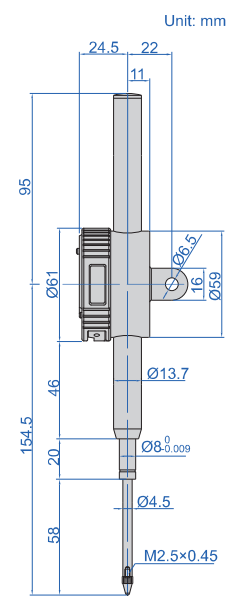

2505-501WL/2505-50WL

- Dust/waterproof
- Built-in wireless transmission
- Transmission distance is 10 meters (under the condition of no obstruction and no electromagnetic interference)
- Button function: on/off, zero, tolerance Go and No-Go display, change measuring direction, max./min./TIR measurement, data preset, mm/inch, data output, absolute/incremental measurement
- Keep preset data and tolerance data in memory after restart
- Automatic power off (time is adjustable)
- Power: rechargeable Li-battery
- Optional accessory: receiver (code 7315-2/3/6/7/8/9), backs, contact points

max./min./TIR

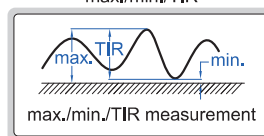

spindle lift knob is included  
(except 2505-101WL/101FWL,  
2505-10WL/10FWL)



alarm when over tolerance



application

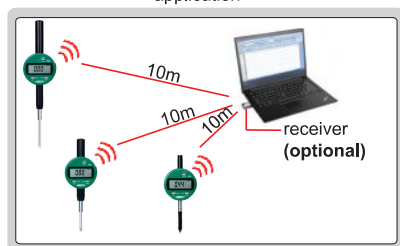

**Resolution 0.001mm/0.00005"**

Code	Range	Dust/waterproof	Accuracy	Hysteresis	Maximum measuring force	Cap	Remark
<b>2505-101WL *</b>	12.7mm/0.5"	IP65	5μm	2μm	1.5N	cannot lift	lug back
<b>2505-251WL *</b>	25.4mm/1"	IP54	5μm	3μm	2.2N	cannot lift	lug back
<b>2505-501WL *</b>	50.8mm/2"	IP54	6μm	3μm	2.5N	cannot lift	lug back
<b>2505-101FWL *</b>	12.7mm/0.5"	IP65	5μm	2μm	1.5N	cannot lift	flat back
<b>2505-251FWL *</b>	25.4mm/1"	IP54	5μm	3μm	2.2N	cannot lift	flat back
<b>2505-501FWL *</b>	50.8mm/2"	IP54	6μm	3μm	2.5N	cannot lift	flat back

**Resolution 0.01mm/0.0005"**

Code	Range	Dust/waterproof	Accuracy	Hysteresis	Maximum measuring force	Cap	Remark
<b>2505-10WL *</b>	12.7mm/0.5"	IP65	20μm	10μm	1.5N	cannot lift	lug back
<b>2505-25WL *</b>	25.4mm/1"	IP54	20μm	10μm	2.2N	cannot lift	lug back
<b>2505-50WL *</b>	50.8mm/2"	IP54	30μm	10μm	2.5N	cannot lift	lug back
<b>2505-10FWL *</b>	12.7mm/0.5"	IP65	20μm	10μm	1.5N	cannot lift	flat back
<b>2505-25FWL *</b>	25.4mm/1"	IP54	20μm	10μm	2.2N	cannot lift	flat back
<b>2505-50FWL *</b>	50.8mm/2"	IP54	30μm	10μm	2.5N	cannot lift	flat back

\*Supplied with manufacturer inspection certificate